

NOM. - CAT. : VER OBSERVACIONES y NOTAS

PROPIETARIO:

**AUTOCREDITO SOCIEDAD ANONIMA
de CAPITALIZACION**
(C.U.I.T. 33-70495331-9)

TELA 2 de 2

OBJETO: MENSURA

INSCRIPCION DEL DOMINIO:

TITULO I: Matrícula N° 3.742/19 Asiento A-2 del Folio Real de San Rafael; Fecha: 13/11/2006
 TITULO II: Matrícula N° 3.743/19 Asiento A-2 del Folio Real de San Rafael; Fecha: 13/11/2006
 TITULO V: Matrícula N° 3.746/19 Asiento A-2 del Folio Real de San Rafael; Fecha: 13/11/2006
 TITULO VI: Matrícula N° 3.747/19 Asiento A-2 del Folio Real de San Rafael; Fecha: 13/11/2006
 TITULO VII: Matrícula N° 3.748/19 Asiento A-2 del Folio Real de San Rafael; Fecha: 13/11/2006
 TITULO VIII: Matrícula N° 3.749/19 Asiento A-2 del Folio Real de San Rafael; Fecha: 13/11/2006

San Rafael, Junio 29 del 2009

SERGIO LEANDRO MARINELLI
Agrimensor - Mat. 1127 - Cuit 20-12.931.596-3
San Lorenzo 90 - 2°F San Rafael

DERECHO DE RIEGO:

NO TIENE
NO TIENE POZO

SUP. SEGUN
MENSURA

VER DETALLE

PADRON TILA: 19/07482-2 TILA: 19/07483-1 TIL.V: 19/07486-3
DE RENTAS TIL.VI: 19/07487-1 TIL.VII: 19/07488-9 TIL.VIII: 19/07489-7

SUP. SEGUN
TITULO

VER OBSERVACIONES y NOTAS

PADRON
MUNICIPAL

CROQUIS DE UBICACION

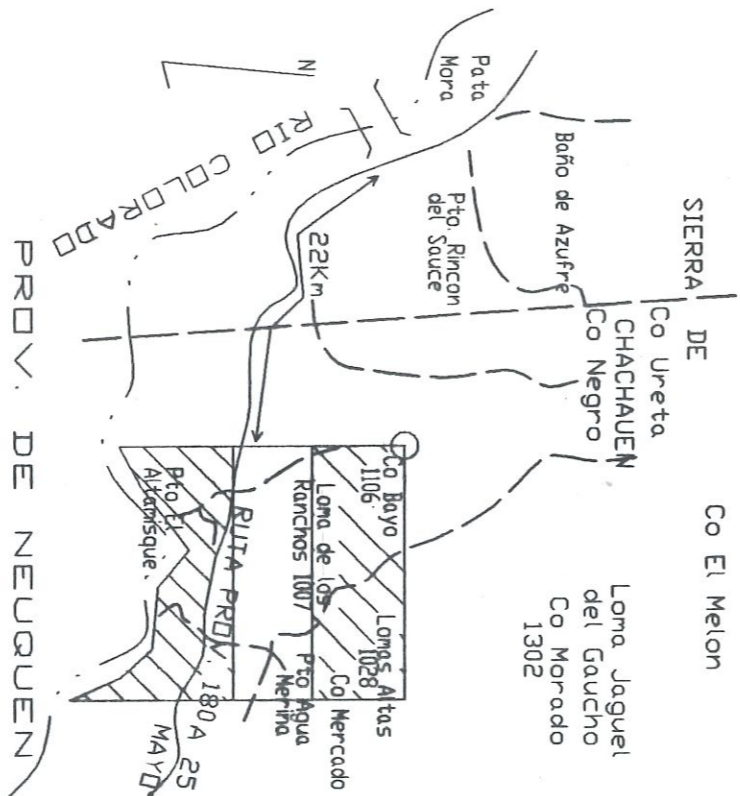

PROVINCIA

MENDOZA

DEPARTAMENTO

MALARGUE

DISTRITO

LA ESCONDIDA

LUGAR

EL ALTAMISQUE

CALLE

**ruta 180 a 25 de MAYO
s/n°**

VISACION

RESPONSABLE: ALDO EXEQUIEL PAGANUCCI
 Documento de Identidad: D.N.I. 31.008.108
 Domicilio: Eva Perón N° 512 Villa Constitución-Santa Fe

PLANILA DE RUTA PROVINCIAL N° 180

GAUSS KRUEGER SISTEMA
PDSAR 98 FAJAS 2

Punto	Distancia	Rumbo	Cued	Angulo	X	Y
1-2	4077.73m	66°24'36" SE	156°37'	587253.7807	2516839.3760	
2-3	1.537.38m	66°24'36" SE	180°00'	5870911.9132	2520576.3436	
3-4	87.04m	02°30'16" SD	111°05'	5870296.6699	2521985.2472	
4-5	86.64m	53°19'04" SE	235°49'	5870209.7103	2521981.4438	
5-6	856.60m	81°00'26" SE	207°41'	5870581.5150	2522050.6613	
6-7	162.35m	69°00'54" SE	168°00'	5870085.4258	2522510.2011	
7-8	730.51m	47°13'24" SE	158°12'	5870027.2948	2522661.757	
8-9	740.26m	02°38'33" SE	153°25'	5869959.2781	2522735.2674	
9-10	44.97m	64°17'05" SE	241°39'	5869803.3116	2522742.4659	
10-11	447.99m	87°26'38" SE	203°10'	5869783.7973	2522782.9859	
11-12	1.044.26m	66°48'55" SE	159°22'	5869763.8178	2523230.5281	
12-13	734.02m	19°24'41" SE	132°36'	5869332.6964	2524191.4568	
13-14	607.11m	12°08'03" SD	148°27'	5869296.4856	2524231.4073	
14-15	167.00m	28°51'20" SE	220°59'	5868642.9379	2524103.7912	
15-16	317.83m	07°53'35" SD	143°15'	5868496.6671	2524184.3895	
16-17	793.18m	68°54'28" SD	118°59'	5868185.0008	2524141.1923	
17-18	70.76m	39°17'22" SD	209°37'	5868115.2428	2523960.1308	
18-19	47.60m	10°13'11" SE	229°31'	5868060.4727	2523915.3189	
19-20	44.98m	28°55'50" SE	198°43'	5868013.6245	2523923.7648	
20-21	91.23m	52°04'25" SE	203°09'	5867974.259	2523945.5232	
21-22	367.95m	65°09'03" SE	193°05'	5867918.185	2524017.4848	
22-23	31.19m	75°31'47" SE	190°23'	5867753.5599	2524351.3694	
23-24	25.71m	73°08'30" NE	211°20'	586755.7669	2524406.1690	
24-25	64.30m	55°08'44" NE	198°00'	586753.2220	2524406.1690	
25-26	129.47m	50°44'26" NE	184°24'	5867799.9725	2524458.9389	
26-27	66.03m	27°40'52" NE	203°04'	5867881.9039	2524559.1844	
27-28	127.04m	04°59'35" NE	202°41'	5867940.3824	2524589.8616	
28-29	221.47m	05°18'02" ND	190°18'	5868066.9461	2524600.9191	
29-30	425.12m	11°38'46" NE	163°03'	5868287.4722	2524580.4597	
30-31	173.69m	45°46'37" NE	145°52'	5868703.8459	2524666.2788	
31-32	246.39m	59°19'34" NE	166°27'	5868824.9897	2524790.7536	
32-33	327.91m	82°59'10" SE	142°19'	5868950.6838	2525002.6676	
33-34	74.08m	73°18'03" SE	170°19'	5868910.6434	2525328.1239	
34-35	25.00m	48°28'06" NE	238°14'	5868889.3573	2525399.0778	
35-36	287.57m	07°27'55" ND	235°56'	5868905.9308	2525417.7898	
36-37	47.44m	24°26'38" NE	148°05'	5869191.0708	2525380.4266	
37-38	115.93m	55°02'58" NE	149°24'	5869234.2579	2525400.0572	
38-39	124.58m	37°57'43" NE	197°05'	5869300.6717	2525495.0799	
39-40	95.97m	79°25'35" SE	117°23'	5869398.8923	2525571.7135	
40-41	52.54m	38°14'40" SE	138°49'	5869381.2816	2525666.0563	
41-42	755.49m	27°06'36" SE	168°52'	5869340.0159	2525698.5810	
42-43	208.80m	51°02'55" SE	203°56'	5869146.7214	2525797.5372	
43-44	685.64m	60°47'00" SE	189°44'	5869015.4576	2525959.9154	
43-44	685.64m	60°47'00" SE	189°44'	5869015.4576	2525959.9154	
44-45	598.52m	54°51'05" SE	174°04'	5868680.7831	2526558.3334	
45-46	903.24m	65°04'58" SE	190°14'	5868336.2173	2527047.7167	
46-47	700.53m	51°25'21" SE	166°20'	5868136.6011	2527477.4140	
47-48	261.15m	34°46'40" SE	163°21'	5867700.8110	2528023.7866	
48-49	51.66m	61°28'25" SE	206°42'	5867486.3057	2528281.7206	
49-50	34.21m	56°18'36" NE	242°13'	5867461.6355	2528218.1077	
50-51	1.720.74m	13°41'53" NE	222°37'	5867480.6143	252824.5760	
51-52	1.795.80m	40°41'41" NE	153°00'	5869152.4114	2528654.0573	
52-53	61.60m	00°11'58" SD	40°31'	5870513.9773	2529824.9650	
53-54	1.749.14m	40°41'41" SD	139°29'	5870452.3801	2529824.7505	
54-55	1.718.00m	13°32'57" SD	207°09'	5869126.1886	25298684.2627	
55-56	73.98m	56°18'36" SD	137°14'	5867456.0022	25298281.7688	
56-57	85.28m	61°28'25" ND	117°47'	5867414.9645	2528220.2123	
57-58	264.79m	34°46'40" ND	153°18'	5867455.6943	2528145.2794	
58-59	689.41m	51°25'21" ND	196°39'	5867673.1890	2527994.2414	
59-60	898.46m	65°04'58" ND	193°40'	5868102.3430	2527456.2166	
60-61	600.02m	54°51'05" ND	169°46'	5868301.4493	2527027.6167	
61-62	686.98m	60°47'00" ND	185°56'	5868464.8836	2526537.0000	
62-63	220.68m	51°02'55" ND	170°16'	5868982.2091	2525937.4179	
63-64	756.82m	27°06'36" ND	156°04'	5869120.9452	2525765.7561	
64-65	33.61m	38°14'40" ND	191°08'	5869318.3174	2525664.7524	
65-66	56.62m	79°25'35" ND	221°11'	5869344.7184	2525643.9437	
66-67	106.26m	37°57'43" SD	242°37'	5869355.1077	2525888.2865	
67-68	111.00m	55°02'58" SD	162°55'	5869271.3283	2525522.9201	
68-69	25.06m	24°26'38" SD	210°36'	5869207.7431	2525431.9428	
69-70	297.38m	07°27'55" SE	211°55'	5869184.9292	2525421.5734	
70-71	68.51m	48°28'06" SD	124°04'	5868890.0692	2525460.2102	
71-72	92.97m	73°18'03" ND	121°46'	5868844.6427	2525408.9222	
72-73	310.87m	82°59'10" ND	189°41'	5868871.3566	2525319.8761	
73-74	227.98m	59°19'34" SD	217°41'	5868909.3162	2525011.3324	
74-75	156.55m	45°46'37" SD	193°33'	5868793.0103	2524815.2464	

75-76	407.33m	11°38'22" SD	214°08'	5868683.8208	2524703.0546
75-76	407.33m	11°38'22" SD	214°08'	5868683.8208	2524703.0546
76-77	218.74m	05°18'02" SE	195°56'	5868284.8612	2524620.8737
77-78	138.67m	04°59'35" SD	169°42'	5868067.0539	2524641.0809
78-79	82.22m	27°40'52" SD	157°19'	5867928.9067	2524629.0114
79-80	139.16m	50°44'26" SD	156°56'	5867856.0961	2524590.8156
80-81	72.18m	55°08'44" SD	175°36'	5867688.0275	2524483.0611
81-82	43.26m	73°08'30" SD	162°00'	5867726.7780	2524423.8310
82-83	46.03m	75°31'47" ND	148°40'	5867714.2331	2524382.4328
83-84	376.17m	65°09'03" ND	169°37'	5867257.366	2524337.8566
84-85	104.00m	52°04'25" ND	166°55'	5867883.8150	2523996.5152
85-86	59.76m	28°55'50" ND	156°51'	5867947.7410	2523914.4768
86-87	72.64m	10°13'11" ND	161°17'	5868000.0422	2523885.5686
87-88	101.85m	39°17'22" NE	130°29'	5868071.5273	2523872.6811
88-89	721.63m	68°54'28" NE	150°23'	5868148.7572	2523935.8692
89-90	281.41m	07°53'35" NE	241°01'	5868213.9192	2524104.8077
90-91	168.67m	28°51'20" ND	216°45'	5868488.9996	2524142.9439
91-92	610.76m	12°08'03" NE	139°01'	5868636.7287	2524061.5421
92-93	729.73m	19°24'41" ND	211°33'	5869233.8477	2524189.9260
93-94	1.019.42m	66°48'55" ND	227°24'	5869322.8402	2524158.5668
94-95	448.90m	87°26'38" ND	200°38'	5869724.1822	2523221.4719
95-96	77.03m	64°17'05" ND	156°50'	5869744.2027	2522773.0141
96-97	741.87m	02°38'33" ND	118°21'	5869777.6280	2522703.6087
97-98	727.59m	47°13'24" ND	224°35'	5869941.0546	2522696.0659
98-99	150.42m	69°00'54" ND	201°48'	5869992.7052	2522640.2430
99-100	869.74m	81°00'26" ND	192°00'	5870046.5742	2522499.7989
100-101	117.60m	53°19'04" ND	152°19'	5870120.1830	2522034.6720
101-102	80.78m	02°30'16" NE	124°11'	5870190.2897	2521940.5562
102-103	1.492.63m	66°24'36" ND	248°55'	5870270.9967	2521944.0861
103-104	4.187.51m	66°24'36" ND	180°00'	5870868.3319	2520576.1920
104-1	100.75m	89°48'02" SE	23°23'	5872544.1316	2516238.6200

DETI

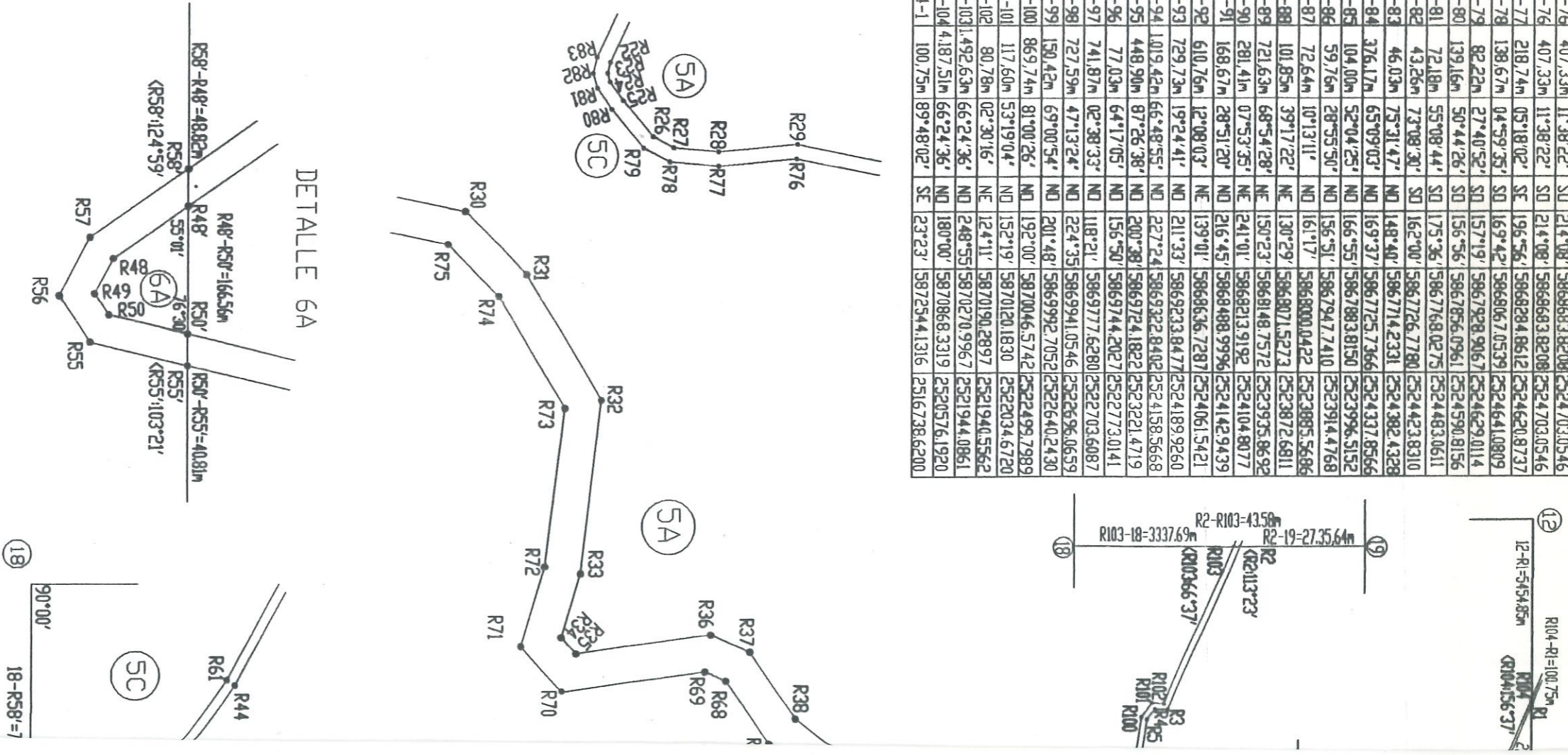

DETALLE 6A